

FLANŞ ÖLÇÜ TABLOSU

ANSI B16.5

Flange Table

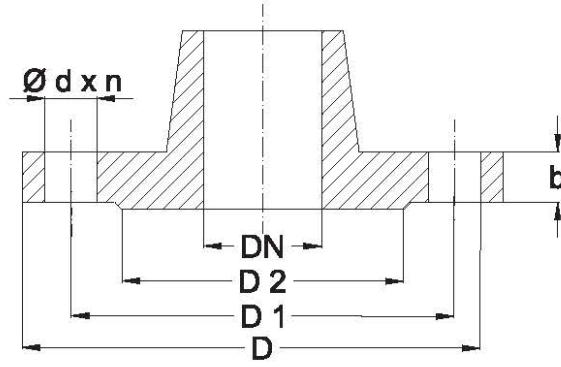

DN	125/150 lbs		300 lbs		400 lbs		600 lbs		900 lbs		1 500 lbs		2500 lbs		
	inch	mm	inch	mm	inch	mm	inch	mm	inch	mm	inch	mm	inch	mm	
5"	øD	10	254	11	279.4	11	279.4	13	330.2	13 3/4	349	14 3/4	375	16 1/2	419
	b	15/16	23.8	1 3/8	34.9	1 1/2	38.1	1 3/4	44.4	2	50.8	2 7/8	73	3 5/8	92.1
	øD2	7 5/16	185.7	7 5/16	185.7	7 5/16	185.7	7 5/16	185.7	7 5/16	185.7	7 5/16	185.7	7 5/16	185.7
	øD1	8 1/2	215.9	9 1/4	234.9	9 1/4	234.9	10 1/2	266.7	11	279	11 1/2	292	12 3/4	324
	n	8	8	8	8	8	8	8	8	8	8	8	8	8	8
6"	ød	7/8	22.2	7/8	22.2	1	25.4	1 1/8	28.6	1 3/8	34.9	1 5/8	41.3	1 7/8	47.6
	øD	11	279	12 1/2	317.5	12 1/2	317.5	14	355.6	15	381	15 1/2	394	19	483
	b	1	25.4	1 7/16	36.5	1 5/8	41.3	1 7/8	47.6	2 3/16	55.6	3 1/4	82.6	4 1/4	108
	øD2	8 1/2	216	8 1/2	215.9	8 1/2	215.9	8 1/2	215.9	8 1/2	215.9	8 1/2	215.9	8 1/2	216
	øD1	9 1/2	241	10 5/8	269.9	10 5/8	269.9	11 1/2	292.1	12 1/2	318	12 1/2	318	14 1/2	368
8"	n	8	8	12	12	12	12	12	12	12	12	12	12	8	8
	ød	7/8	22.2	7/8	22.2	1	25.4	1 1/8	28.6	1 1/4	31.8	1 1/2	38.1	2 1/8	54
	øD	13 1/2	342.9	15	381	15	381	16 1/2	419	18 1/2	470	19	482.6	21 3/4	552
	b	1 1/8	28.6	1 5/8	41.3	1 7/8	47.6	2 3/16	55.6	2 1/2	63.5	3 5/8	92.1	5	127
	øD2	10 5/8	269.9	10 5/8	269.9	10 5/8	269.9	10 5/8	269.9	10 5/8	269.9	10 5/8	269.9	10 5/8	269.9
10"	øD1	11 3/4	298.4	13	330.2	13	330.2	13 3/4	349.2	15 1/2	394.2	15 1/2	394.2	17 1/4	438
	n	8	8	12	12	12	12	12	12	12	12	12	12	12	12
	ød	7/8	22.2	1	25.4	1 1/8	28.6	1 1/4	31.8	1 1/2	38.1	1 3/4	44.5	2 1/8	54
	øD	16	406.4	17 1/2	444.5	17 1/2	444.5	20	508	21 1/2	546	23	584	26 1/2	673
	b	1 3/16	30.2	1 7/8	47.6	2 1/8	54	2 1/2	63.5	2 3/4	69.8	4 1/4	108	6 1/2	165
12"	øD2	12 3/4	323.8	12 3/4	323.8	12 3/4	323.8	12 3/4	323.8	12 3/4	323.8	12 3/4	323.8	12 3/4	323.8
	øD1	14 1/4	361.9	15 1/4	387.4	15 1/4	387.4	17	431.8	18 1/2	470	19	482.6	21 1/4	540
	n	12	12	16	16	16	16	16	16	16	16	12	12	12	12
	ød	1	25.4	1 1/8	28.6	1 1/4	31.8	1 3/8	34.9	1 1/2	38.1	2	50.8	2 5/8	66.7
	øD	19	482.6	20 1/2	520.7	20 1/2	520.7	22	558.8	24	610	26 1/2	673	30	762
14"	b	1 1/4	31.7	2	50.8	2 1/4	57.2	2 5/8	66.7	3 1/8	79.4	4 7/8	124	7 1/4	184
	øD2	15	381	15	381	15	381	15	381	15	381	15	381	15	381
	øD1	17	431.8	17 3/4	450.9	17 3/4	450.9	19 1/4	488.9	21	533.4	22 1/2	571.5	24 3/8	619
	n	12	12	16	16	16	16	20	20	20	20	16	16	12	12
	ød	1	25.4	1 1/4	31.8	1 3/8	34.9	1 3/8	34.9	1 1/2	38.1	2 1/8	54	2 7/8	73
16"	øD	21	533.4	23	584	23	584	23 3/4	603	25 1/4	641	29 1/2	749		
	b	1 3/8	34.9	2 1/8	54	2 3/8	60.3	2 3/4	69.8	3 3/8	85.7	5 1/4	133		
	øD2	16 1/4	412.7	16 1/4	412.7	16 1/4	412.7	16 1/4	412.7	16 1/4	412.7	16 1/4	412.7		
	øD1	18 3/4	476.2	20 1/4	514.4	20 1/4	514.4	20 3/4	527	22	558.8	25	635		
	n	12	12	20	20	20	20	20	20	20	20	16	16		
18"	ød	1 1/8	28.6	1 1/4	31.8	1 3/8	34.9	1 1/2	38.1	1 5/8	41.3	2 3/8	60.3		
	øD	23 1/2	596.9	25 1/2	647.7	25 1/2	648	27	686	27 3/4	705	32 1/2	826		
	b	1 7/16	36.5	2 1/4	57.2	2 1/2	63.5	3	76.2	3 1/2	88.9	5 3/4	146		
	øD2	18 1/2	470	18 1/2	470	18 1/2	470	18 1/2	470	18 1/2	470	18 1/2	470		
	øD1	21 1/4	539.8	22 1/2	571.5	22 1/2	571.5	23 3/4	603.3	24 1/4	616	27 3/4	705		
20"	n	16	16	20	20	20	20	20	20	20	20	16	16		
	ød	1 1/8	28.6	1 3/8	34.9	1 1/2	38.1	1 5/8	41.3	1 3/4	44.4	2 5/8	66.7		
	øD	25	635	28	711	28	711	29 1/4	743	31	787	36	914		
	b	1 9/16	39.7	2 3/8	60.3	2 5/8	66.7	3 1/4	82.6	4	102	6 3/8	162		
	øD2	21	533.4	21	533.4	21	533.4	21	533.4	21	533.4	21	533.4		
24"	øD1	22 3/4	577.9	24 3/4	628.7	24 3/4	628.7	25 3/4	654.1	27	685.8	30 1/2	775		
	n	16	16	24	24	24	24	20	20	20	20	16	16		
	ød	1 1/4	31.8	1 3/8	34.9	1 1/2	38.1	1 3/4	44.5	2	50.8	2 7/8	73		
	øD	27 1/2	698.5	30 1/2	774.7	30 1/2	774.7	32	813	33 3/4	857	38 3/4	984		
	b	1 11/16	42.9	2 1/2	63.5	2 3/4	69.8	3 1/2	88.9	4 1/4	108	7	178		
24"	øD2	23	584.2	23	584.2	23	584.2	23	584.2	23	584.2	23	584.2		
	øD1	25	635	27	685.8	27	685.8	28 1/2	724	29 1/2	749.3	32 3/4	832		
	n	20	20	24	24	24	24	24	24	20	20	16	16		
	ød	1 1/4	31.8	1 3/8	34.9	1 5/8	41.3	1 3/4	44.5	2 1/8	54	3 1/8	79.4		
	øD	32	812.8	36	914	36	914	37	940	41	1041	46	1168		
24"	b	1 7/8	47.6	2 3/4	69.8	3	76.2	4	102	5 1/2	140	8	203		
	øD2	24 1/4	692.2	27 1/4	692.2	27 1/4	692.2	27 1/4	692.2	27 1/4	692.2	27 1/4	692.2		
	øD1	29 1/2	749.3	32	812.8	32	812.8	33	838.2	35 1/2	902	39	991		
	n	20	20	24	24	24	24	24	24	20	20	16	16		
	ød	1 3/8	34.9	1 5/8	41.3	1 7/8	47.6	2	50.8	2 5/8	66.7	3 5/8	92.1		